

ZONE	REV	DESCRIPTION	REVISIONS	DATE	APPROVED

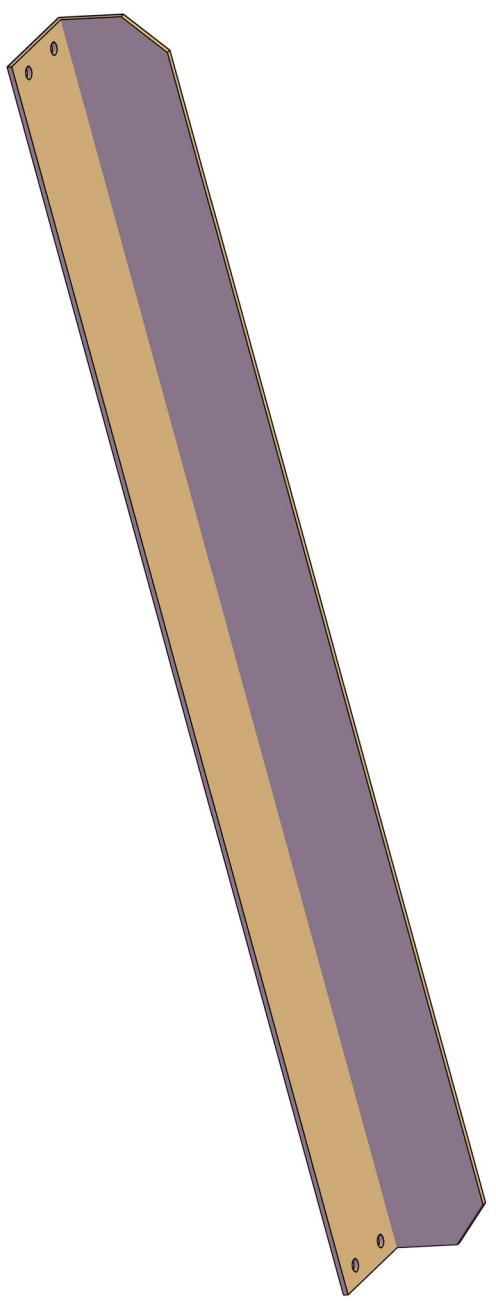
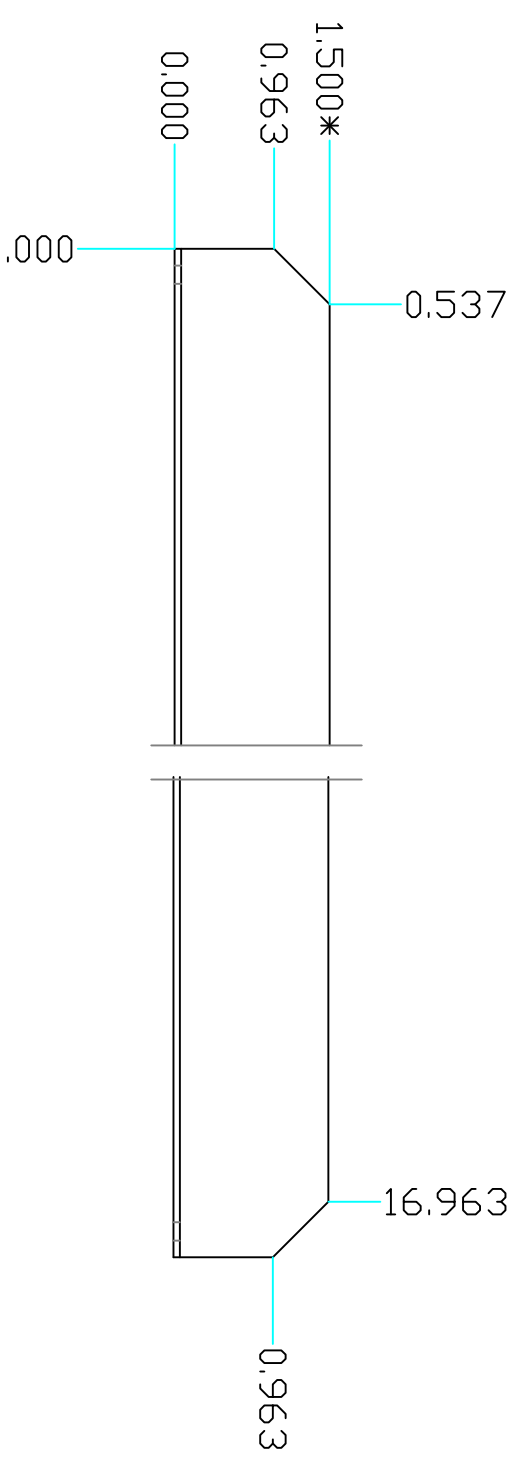
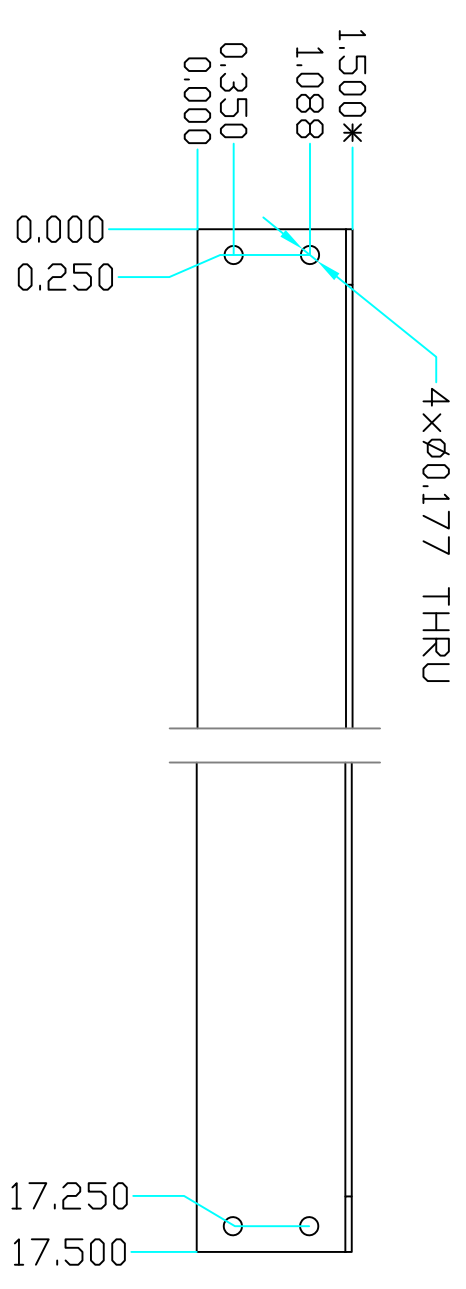

A

B

C

D

6 5 4 3 2 1



1. DIMENSIONS ARE IN INCHES.  
 2. MACHINE SURFACES TO BE FLAT, SQUARE, PARALLEL & CONCENTRIC BELT 12 WITHIN .001 FIVE 5 INCHES OR .001 TIR AS APPLICABLE.  
 3. MARK ALL DETAILS EXCEPT COMMERCIAL PARTS WITH DIMS & ITEM NUMBER.  
 4. BREAK ALL SHARP CORNERS .01 x 45° CHAMFER.  
 5. FILET'S SHOWN SHARP = 1/4 RADIUS.  
 6. TYPICAL MESH BEAD CLASS B3 THROUGH. MIN DEPTH .15 x DIM.  
 7. CUSTOMER'S BEAD TOLERANCES 1/16 x 90°.  
 8. CENTERS PERMISSIBLE.  
 9. DO NOT SCALE DRAWING.  
 10. ALL WELDING TO CONFORM TO LATEST AWS STANDARDS.

FINO/REF#	QTY.	UM.	PART NAME	MATERIAL	PART DESCRIPTION	REF. SHEET/DWG.
1	EA	ANGLE	ALUMINUM 6063	Architectural 90 Degree Angle	Master#488895K3	227.00.05.00

PARTS LIST		PERMISSIBLE VARIATION IN INCH DIMENSIONS WITHOUT TOLERANCES		MACHINING TOLERANCES	
12 TO 60	±0.10	BEHIND PLACES X & XX	XXX	XXX	XXX
60 TO 180	±0.13	BEHIND 18	±0.00	±0.05	±0.02
18 TO 48	±0.20	OVER 18	±0.00	±0.04	±0.04
OVER 180	±0.30	OVER 48	±0.00	±0.05	±0.04

SIZE	SCALE	SURFACE TEXTURE
D	1:1	32

NAME	DATE	TOLERANCES ARE NOT ACCUMULATIVE
AD	05/06/22	

DESIGNED	CHECKED	APPROVED	TITLE
KH	KH	KH	DFPS SETUP 4X4 JIG, SIDE ANGLE

DRAWING NUMBER	DRAWING NUMBER	REVISION
227	227.00.05.02	1 DF 1

COMPANY	PROJECT NUMBER	REVISION
Open Source Instruments Inc.	227	A

DATE	REVISION
05/06/22	1

DATE	REVISION
05/06/22	1

DATE	REVISION
05/06/22	1

DATE	REVISION
05/06/22	1

DATE	REVISION
05/06/22	1

DATE	REVISION
05/06/22	1

DATE	REVISION
05/06/22	1

DATE	REVISION
05/06/22	1

DATE	REVISION
05/06/22	1